

THE LAMAR

COLONIAL SERIES
2122 SQ FT



Elevation A



Elevation A
(with stone)



Elevation A
(with extended garage)



Elevation A
(with 3 car garage)



Elevation A, Second Story
(with bonus bedroom 5 & bath 4)



Elevation A, Second Story
(with extended garage, bonus
bedroom 5, & bath 4)



Elevation A, Second Story
(with 3 car garage, bonus
bedroom 5, & bath 4)

For more information, visit www.mckinleyhomeshouston.com

©2024 McKinley Homes US, LLC. Plans, features, pricing and availability are subject to change without prior notice or obligation and may vary by elevation. Information including square footage is approximate and subject to change without prior notice or obligations. Images are an artist's conceptions and not a guarantee of final specifications. Please see our sales professional for details and additional information.

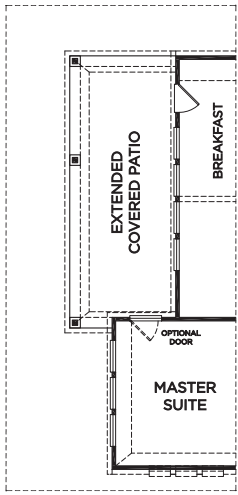

OPTIONAL EXTENDED COVERED PATIO

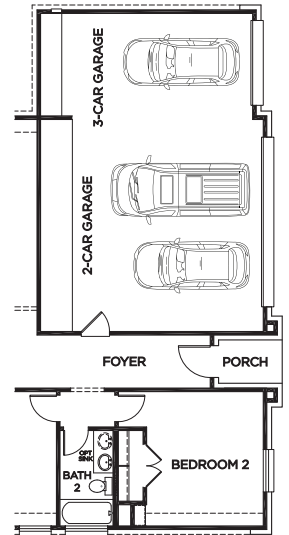
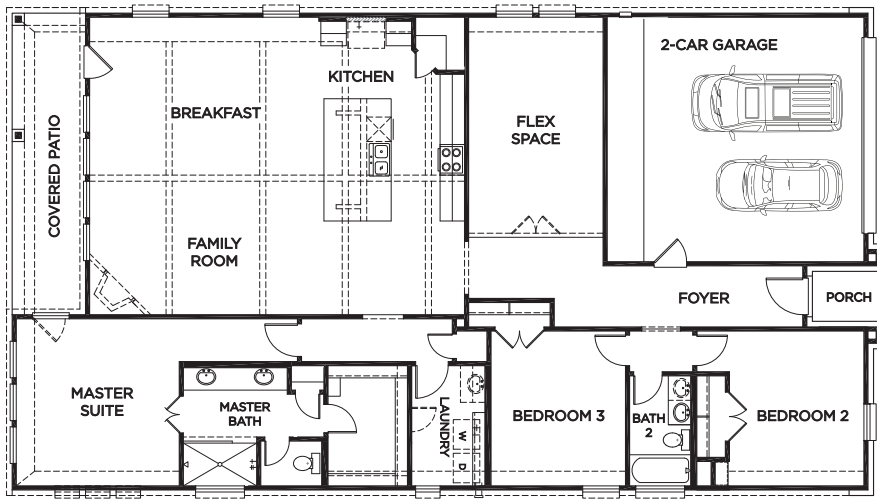

OPTIONAL 3-CAR GARAGE

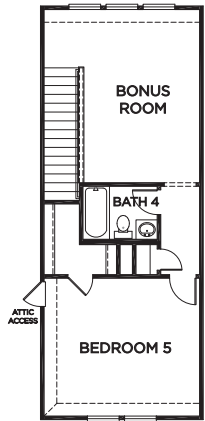

OPTIONAL SECOND FLOOR BONUS ROOM, BEDROOM 5, & BATH 4

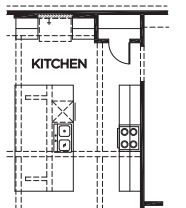

OPTIONAL PASS THROUGH IN KITCHEN

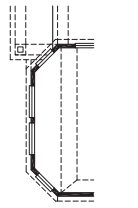

OPTIONAL MASTER BAY WINDOW

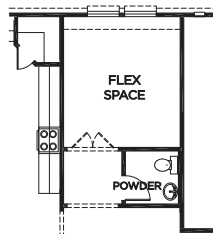

OPTIONAL POWDER ROOM

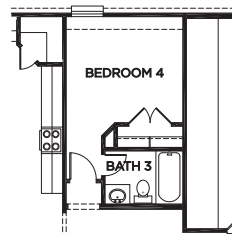

OPTIONAL BEDROOM 4 WITH BATH 3

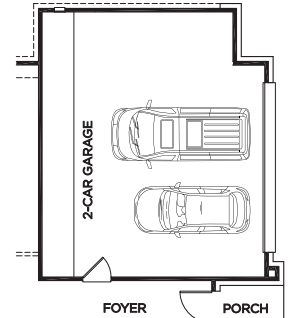

OPTIONAL 5 FT. EXTENDED GARAGE

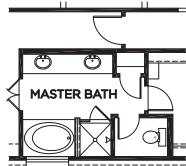

OPTIONAL SEPARATE MASTER BATH TUB & SHOWER

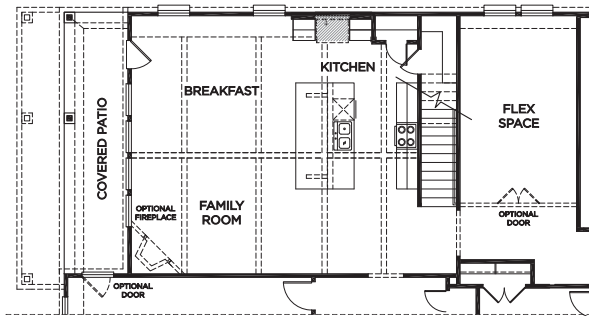

OPTIONAL STAIRS WITH BONUS ROOM, BEDROOM 5, & BATH 4

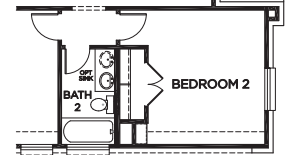

OPTIONAL PASS THROUGH AT STAIRS

THE LAMAR

Approximate Square Footage: 2122

3 Bedrooms / 2 Baths

Optional Bedroom 4 / Bath 3

Optional Extended Covered Patio

For more information, visit www.mckinleyhomeshouston.com

©2024 McKinley Homes US, LLC. Plans, features, pricing and availability are subject to change without prior notice or obligation and may vary by elevation. Information including square footage is approximate and subject to change without prior notice or obligations. Images are an artist's conceptions and not a guarantee of final specifications. Please see our sales professional for details and additional information.